



[www.doyon.qc.ca](http://www.doyon.qc.ca) • [www.nu-vu.com](http://www.nu-vu.com)

## JA8

### JET-AIR OVEN

The JA series from Doyon is known worldwide for its unique JET AIR SYSTEM. The air moves in one direction, stops then moves the other way resulting in a bidirectional and gentle velocity air flow for exceptional baking results. This system will help you bake faster and more evenly without having to turn pans during baking time. The Jet Air fan system will save energy and labor costs.

The JA8 provides great flexibility in terms of range of products that can be baked or cooked. It features a programmable or manual one shot and constant pulse steam injection. To get the results you really want, we have added as standard a fan delay for those delicate products.



JA8  
(shown with optional stand)

### STANDARD FEATURES

#### OVEN

- Outstanding steam shot and pulse injection system
- Reversing fan system
- Two speeds fan
- Fan delay switch
- High production oven
- Manual mode and user friendly EBake programmable control up to 99 recipes
- Digital temperature control up to 500°F
- Digital reminder timer
- USB Port
- Brightly lit, compact space saving unit
- Full view heat reflective thermal glass doors
- Fully insulated, completely sealed
- Energy efficient electric or gas heating (baking temperature reached in 15 minutes)
- Magnetic latches
- Door switch cutoff for fan blower
- Stainless steel inside and outside
- 3/4 HP motor
- 2 year parts 1 year labor limited warranty

#### OPTIONS

- Stand with locking casters (JA8B)
- Perforated nickel plated pizza decks
- High temperature gasket for baking over 400°F (250°C)
- Water softener: PLF240
- Gas quick disconnect kit (4' (1120 mm) flexible hose, ball valve and securing device)

*Experience our top-of-the-line ovens today!*



5600 13th Street • Menominee, MI 49858 USA

Phone: 906-863-4401

E-mail: [sales@nu-vu.com](mailto:sales@nu-vu.com)

Toll Free: 1-800-338-9886

[www.doyon.qc.ca](http://www.doyon.qc.ca)

Fax: 906-863-5889

[www.nu-vu.com](http://www.nu-vu.com)

## OVERALL DIMENSIONS

JA8 36 3/8" W X 52" D X 41 5/8" H

(924 mm X 1321 mm X 1057 mm)

JA8G 36 3/8" W X 54 1/2" D X 41 5/8" H

(924 mm X 1384 mm X 1057 mm)

## OVEN INTERIOR DIMENSIONS

JA8 23 1/2" W X 31" D X 33 1/2" H

(597 mm X 787 mm X 851 mm)

JA8G 23 1/2" W X 30" D X 33 1/2" H

(597 mm X 762 mm X 851 mm)

Shelf spacing 3 1/2" (89 mm)

## ELECTRICAL SYSTEM

### JA8

#### 1 Phase:

208V - 51 A - 10.8 kW - 60 Hz - 3 wires + Ground

240V - 45 A - 10.8 kW - 60 Hz - 3 wires + Ground

#### 3 Phases:

208V - 33 A - 10.8 kW - 60 Hz - 4 wires + Ground

240V - 28 A - 10.8 kW - 60 Hz - 4 wires + Ground

**Other voltages available**

## GAS SYSTEM

### JA8G (Propane or natural)

BTU total: 65 000

Voltage:

1 Phase:

120V - 10A - 1.2 kW - 60Hz - 2 wires + Ground NEMA 5-15P

Gas inlet: 1/2" NPT

Draft hood : 6" (152 mm)

Recommended gas pressure:

Propane gas : 11" W.C.

Natural gas : 7" W.C.

## WATER INLET: 1/4" NPT

Minimum clearance from combustible material

1" (25 mm) side and back

4" (102 mm) on non combustible floor

12" (305 mm) top

**FINISH:** Stainless steel

## SHIPPING WEIGHT

JA8 840 lb (381 kg) approximately

JA8G 900 lb (409 kg) approximately

JA8B 200 lb (90 kg) approximately

## CAPACITY

Standard sheet pans 18" X 26" (457 mm X 660 mm): 8 pans

Four-straped bread pans: 16 loaves

9" (230 mm) pies: 40 pies

Electrical service connection and water inlet are located at the back of the unit.

Specifications and design are subject to change without notice.

## JA8

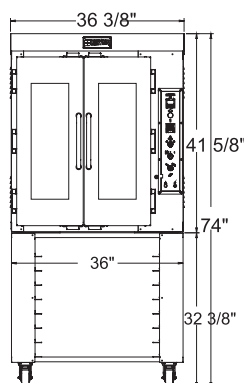

## JA8G

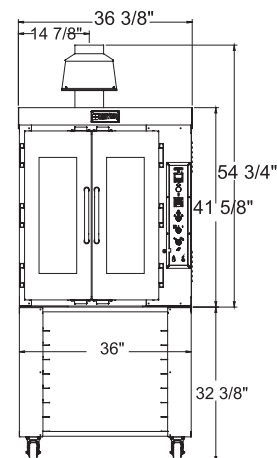

Shown with optional stand  
Montré avec base optionnelle

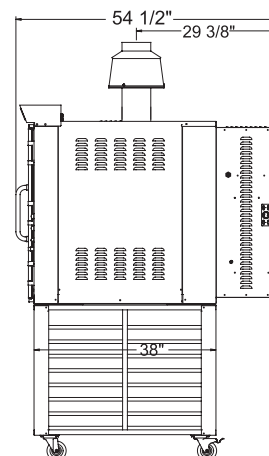
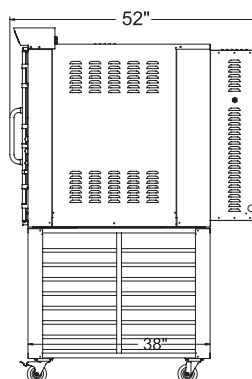

DRAFT HOOD 6" (152 mm)  
COUPE TIRAGE 6" (152 mm)

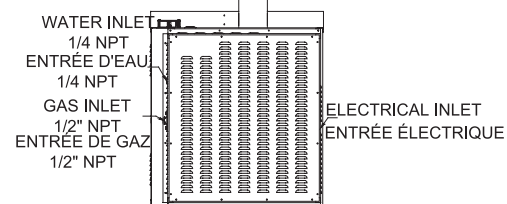
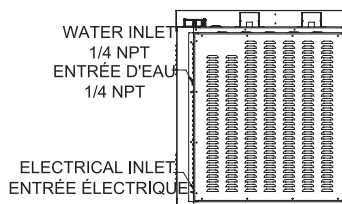

5600 13th Street • Menominee, MI 49858 USA

Phone: 906-863-4401 E-mail: sales@nu-vu.com

Toll Free: 1-800-338-9886 www.doyon.qc.ca

Fax: 906-863-5889 www.nu-vu.com

